

5. DIZALICE, KOLICA I HVATALJKE Hoists, clamps

5.2. Hvataljke

Magnetna hvataljka RX-lift

Permanent magnetic lifter RX-lift

2.1 2.2 CE MTCB

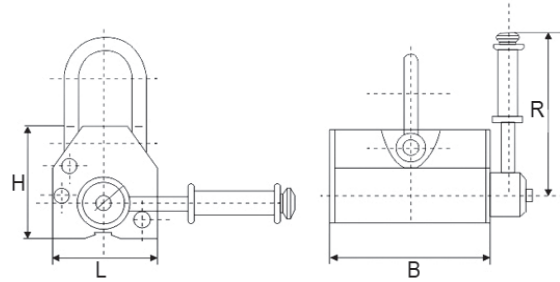
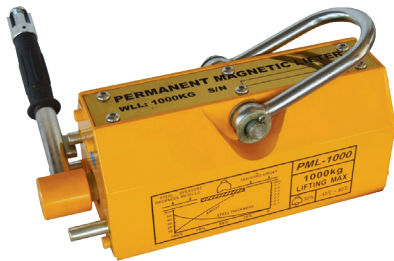

- faktor sigurnosti: 3,5:1
- strogo zabranjeno preopterećivanje

• VAŽNO: kapacitet dizanja ovisi o debljini i kemijskom sastavu materijala i hrapavosti površine na koju se hvataljka pričvršćuje

Model	Nosivost (kg)	Nosivost kod cilindričog elementa (kg)	Prekidna sila (kN)	L (mm)	B (mm)	H (mm)	R (mm)	Dozvoljena radna temperatura (°C)	Neto težina (kg)
	WLL	Cylindrical element WLL	Breakaway force					Work temperature	Net. weight
PML-100	100	30	350	62	92	70	145	<80	3
PML-300	300	100	1050	92	162	96	180	<80	10
PML-500	500	150	1750	120	216	118	220	<80	20
PML-600	600	200	2100	122	232	120	220	<80	24
PML-1000	1000	300	3500	176	258	163	285	<80	50
PML-2000	2000	600	7000	234	378	212	465	<80	125
PML-3000	3000	1000	10500	286	458	261	565	<80	220
PML-6000	6000	2000						<60	

